

MFN 86 *XSafe*

Modular Ice Machine 1900 kg

Item #:

Project:

Quantity:



FEATURES

- Semi-hermetic compressor. Stainless steel auger and freezing cylinder (evaporator). Equipped with an electromechanical control board.
- Ice breaker made in specially strengthened alloy, allowing for greater extrusion pressure to deliver a dryer-quality of nugget ice (92% dry).
- Long-lasting stainless steel roller-bearings.
- Double protection - electronic rotation sensor and drive coupling - on gear motor and gear reducer.
- Low- water sensor protection on refrigeration and gear motor system. Ice level thermostat for machine shut down.
- Stainless steel side panels in scotch-brite finish, with rounded corners for enhanced ease of cleaning and aesthetics.
- Side panels are removable on all four sides to ease maintenance and after-sales service operations.
- PS plastic top cover. Reduced height to ease installation.

CONDENSING SYSTEM

Air cooled

REFRIGERANT GAS

R452A

VOLTAGE V/Hz/ph

400/50/3N

RECOMMENDED BINS

Head	Bins		kg
MFN 86	●	UBH2250	1068
	●	SIS1350	613 + 73 + 73

LEGEND:

- ✓ : Perfect combination between ice maker and bin
- : Ice chute cut-out performed upon installation
- CBTxxxxxxxx : need additional bin top



MFN M 86
Nugget Medium 1 g
Ø 13,5 x H 13 mm

CERTIFICATIONS



OPERATING REQUIREMENTS

	Minimum	Maximum
Air temperature	10	43
Water temperature	5	38
Water pressure	1 bar (14 psi)	5 bar (70 psi)
Electrical voltage	-10%	+10%

IMPORTANT NOTICE:
Models and specifications are subject to change without notice.
This spec sheet is meant for commercial purpose only.
For technical documentation please refer to our service manuals.

Download our free **App Scotsman Ice**
Apple store
Google play
Windows store



www.scotsman-ice.it
www.scotsman-ice.com

Modular Ice Machine 1900 kg

MFN 86 *XSafe*

Modular Ice Machine 1900 kg

Item #:
Project:
Quantity:

Modular Ice Machine 1900 kg

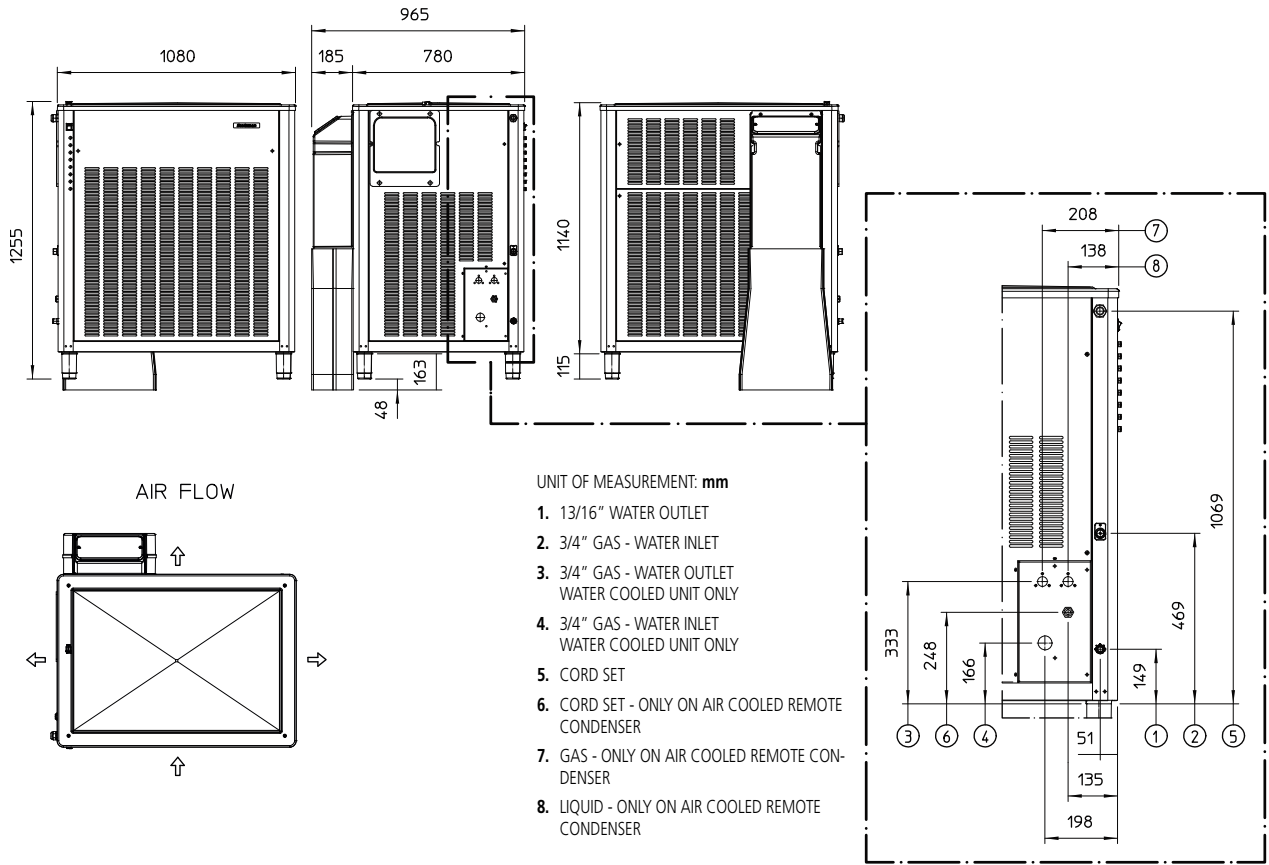

UNIT DATA		SHIPPING DATA									
Size (W x D x H)	1080 x 780 x 1255 mm	Carton (W x D x H)	1170 x 920 x 1340 mm								
Net weight	362 kg	Weight	383 kg								
		24 h ice production kg °C Amb. / °C Water			Energy consumption (*)		Water usage (*)	Instant power	Compressor	Circuit wires	Max. fuse size
Version	Voltage	10°C/10°C	21°C/10°C	32°C/21°C	kWh/100 kg	kWh/24h	l/h	W	W	No. x Ømm²	A
MFN M86 AS	400/50/3N	1900	1850	1500	9.6	149.0	64.6	6400	10000	5 x 4.0	25

(*) Data refer to 32°C Amb. / 21°C Water temperature conditions